

To Project

To Conceal

To Appear

To Befriend

To Take

To Attract

To Age

To Interpret

To Segregate

To Judge

To Endanger

To Perform

1805 1810 1815 1820 1825 1830 1835 1840 1845 1850 1855 1860 1865 1870 1875 1880 1885 1890 1895 1900 1905 1910



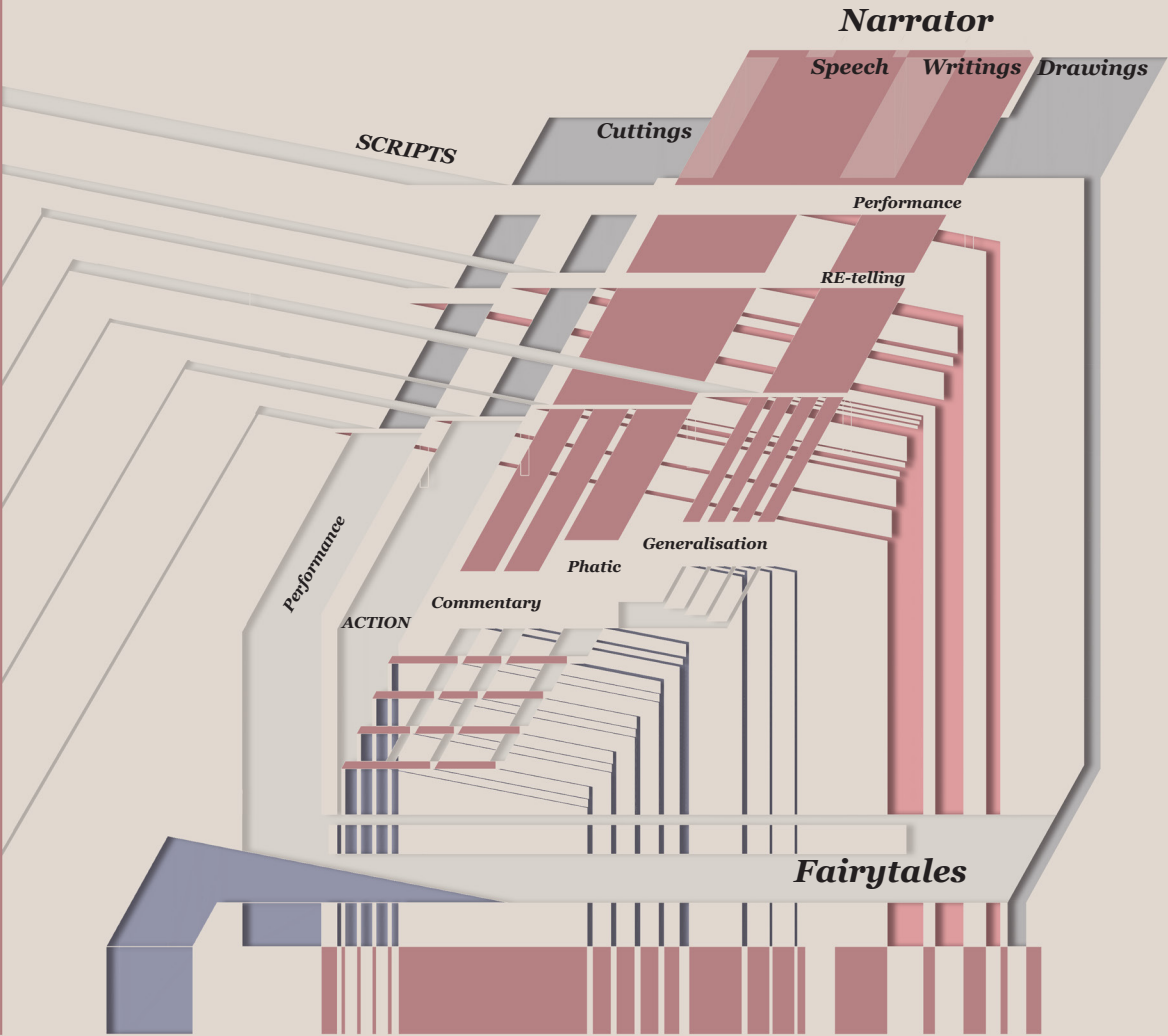
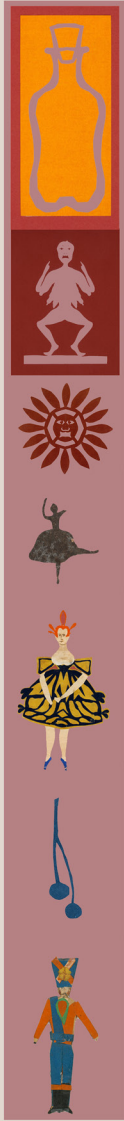

Narrator

Speech Writings Drawings

SCRIPTS

Cuttings

Performance

RE-telling

Performance

ACTION

Commentary

Phatic

Generalisation

Fairytale

Narratee

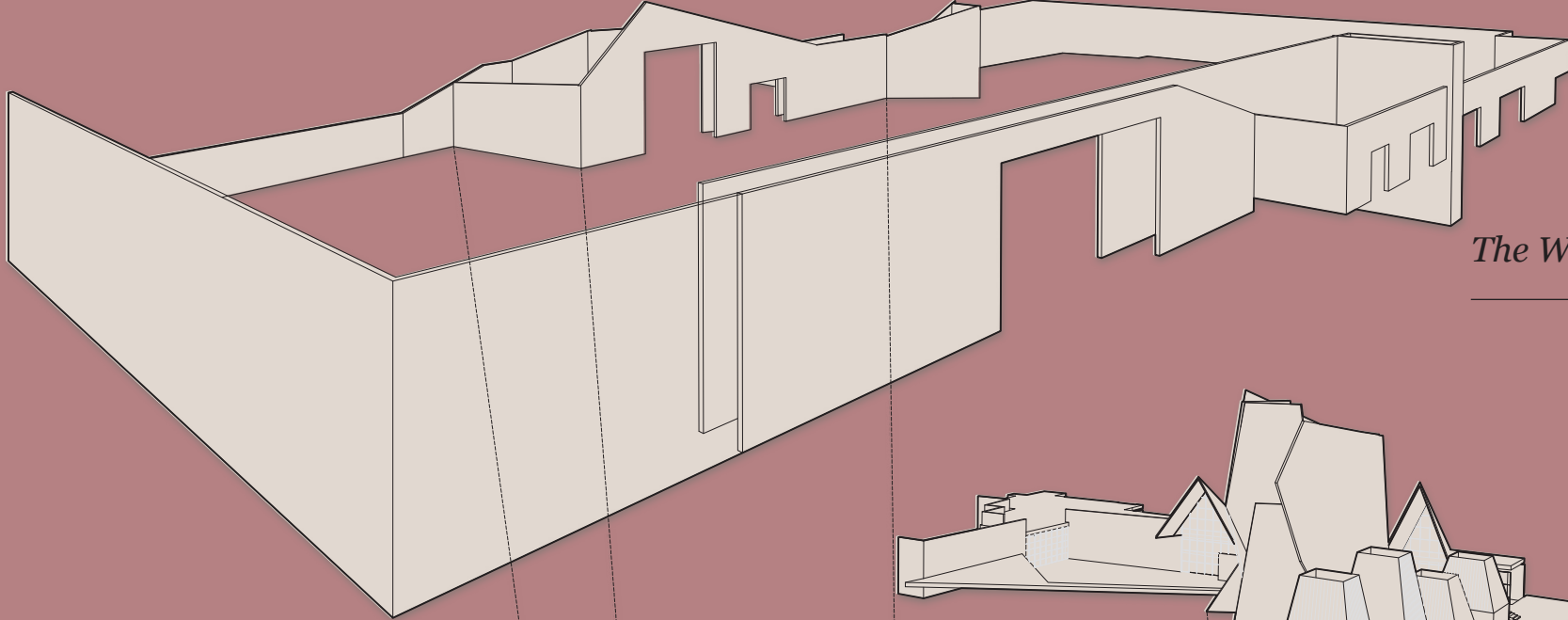

The Wall That's Not A Wall

The Walled Garden

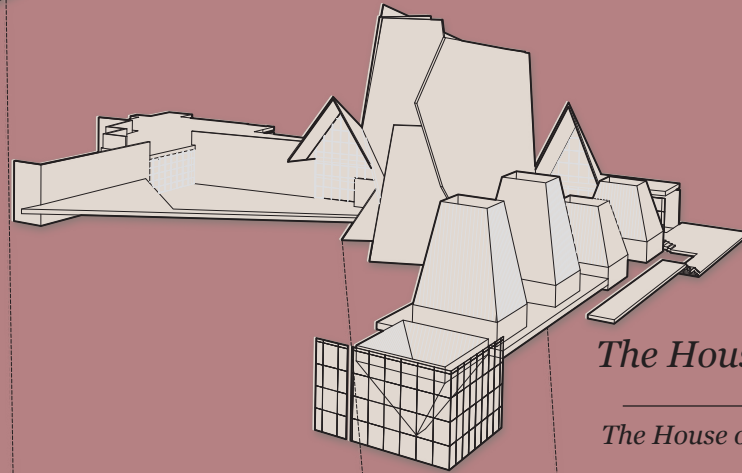

The House That's Not A House

The House of Fairytales as a public tower

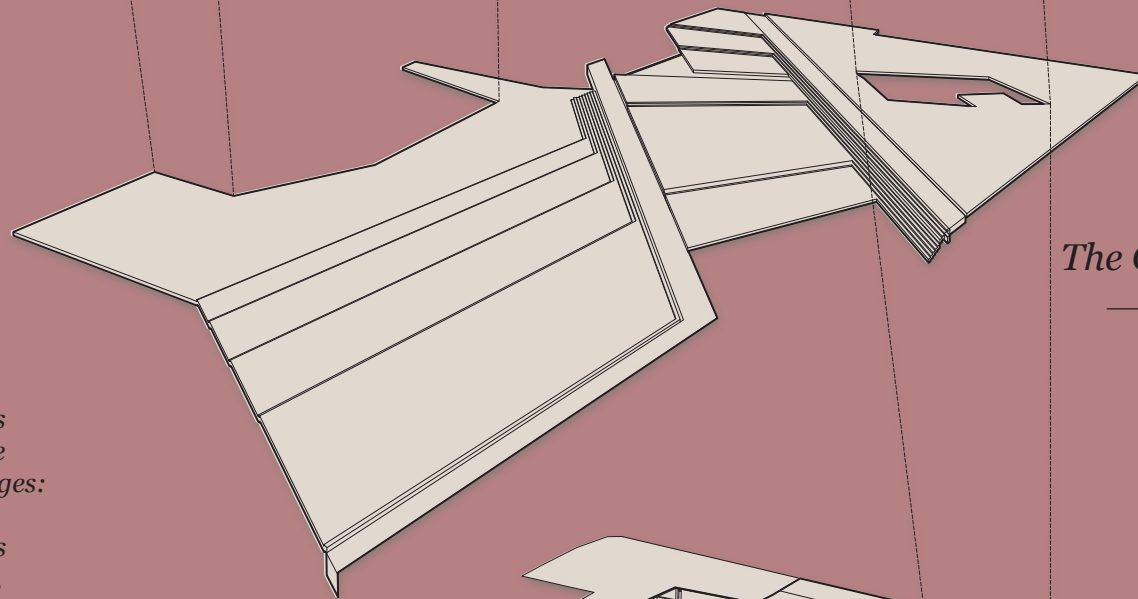

The Garden That's Not a Garden

The Landscape of Child

The Performance of Scripts

*The Telling of Actants roles & obligations
in a given Tale is made interesting by the
Constructing of Stages for mediating Messages:*

*In the Wall through Living Performances
In the House through, Perfomative tales,
In the Landscape of child through the stadium
designed plays*

*In the buildings through the curation of scripts,
actants and networks.*

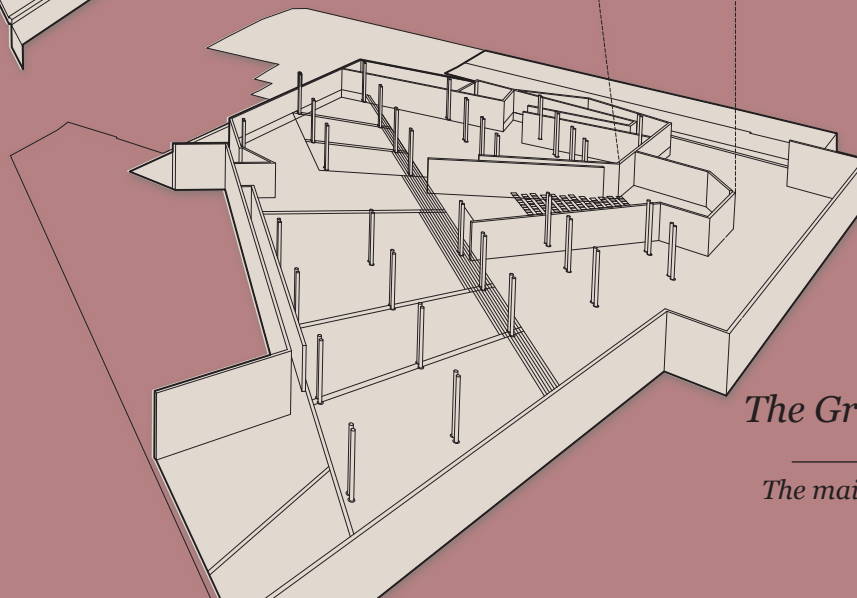

The Ground That's Not a Ground

The main Exhibition and Presentation Hall

*Carl Nielson Museum
in the Distance*

HCA Museum Entrance

The House of Fairytales

Odense Cathedral

*Hans Christian Anderson Child-
hood home*

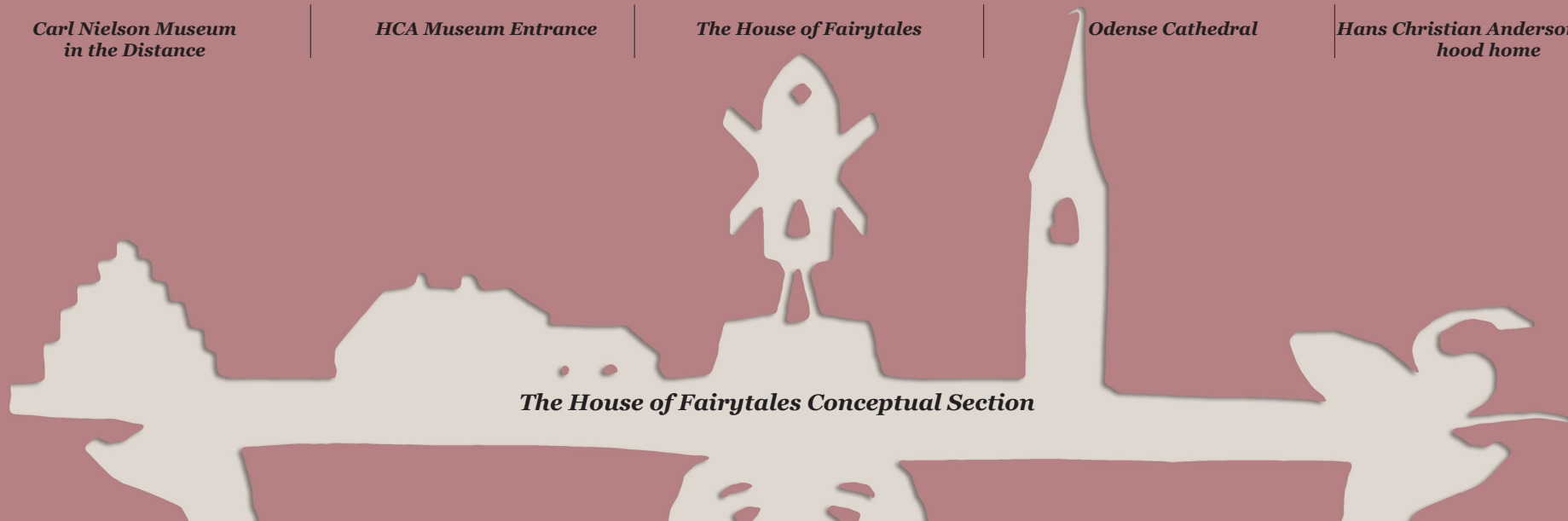

The House of Fairytales Conceptual Section

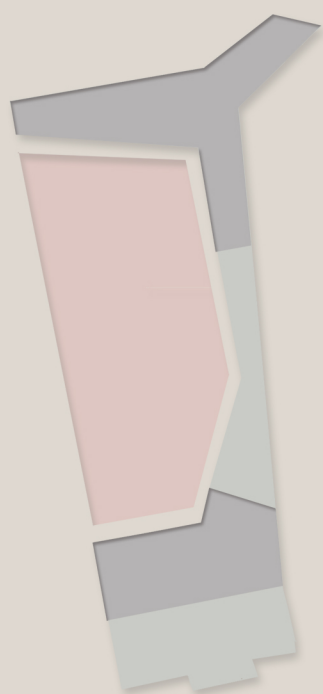
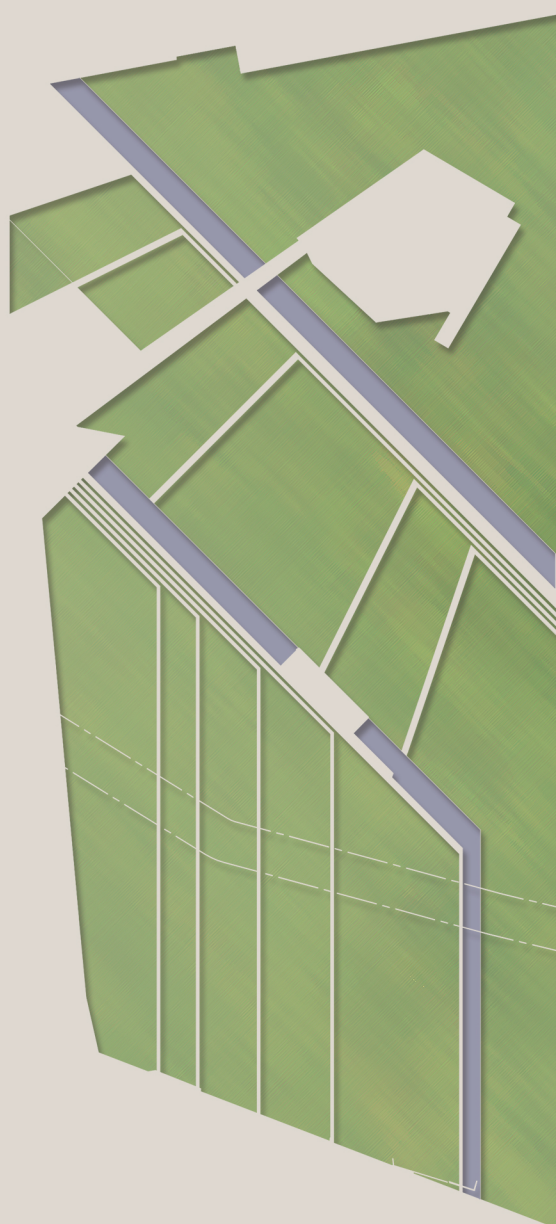
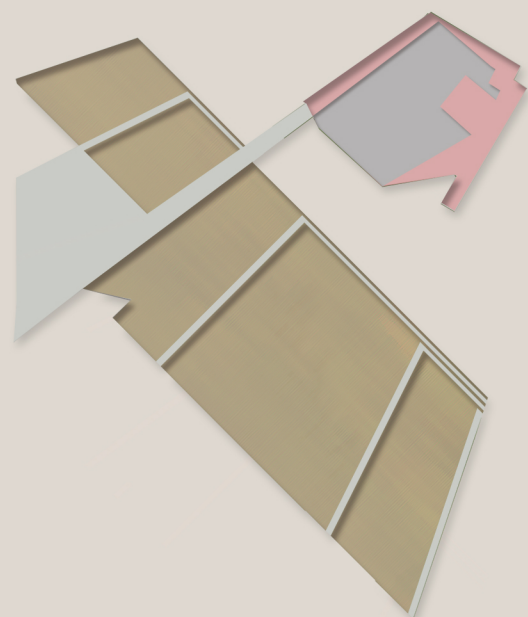
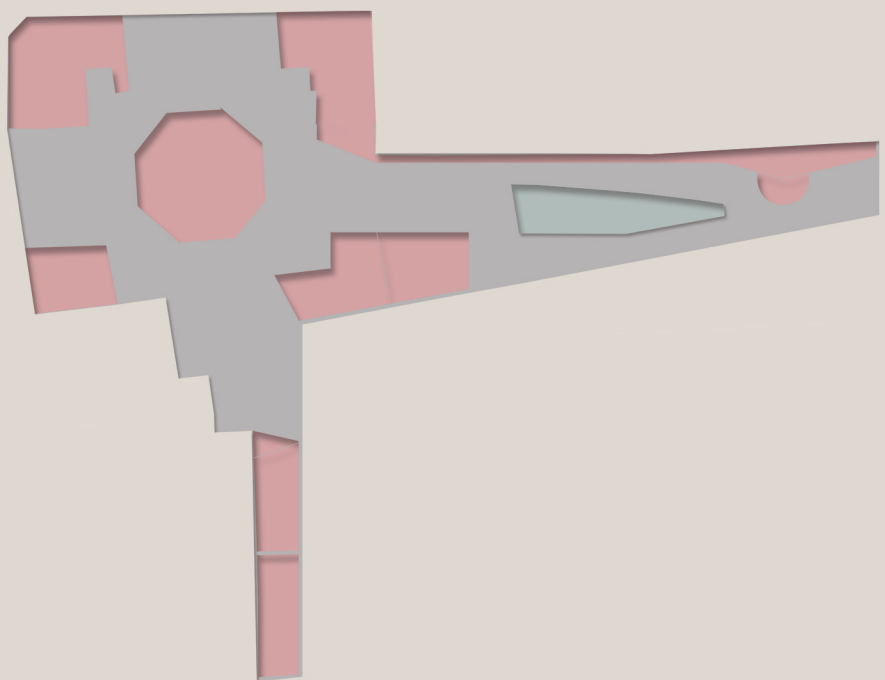

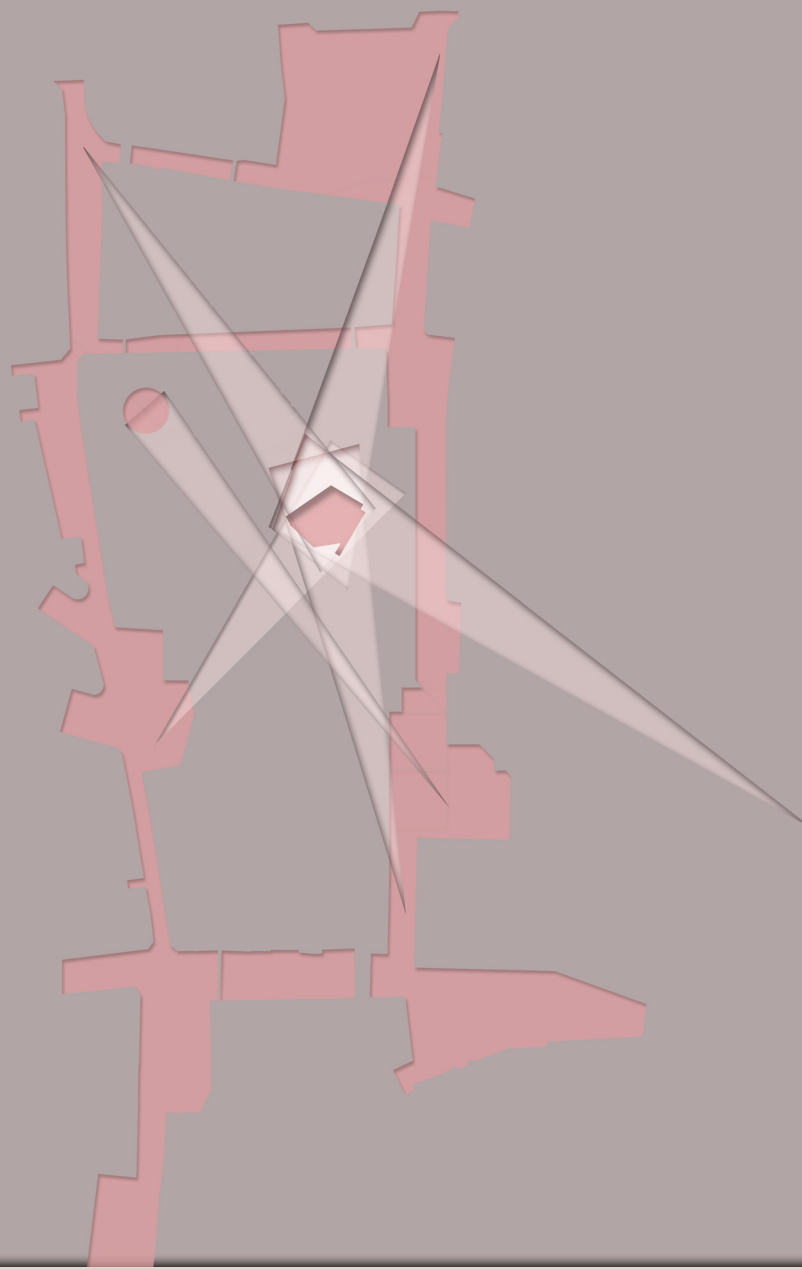

Contextual Visual Unity
with establishment of coherent Vistas and Landmarks

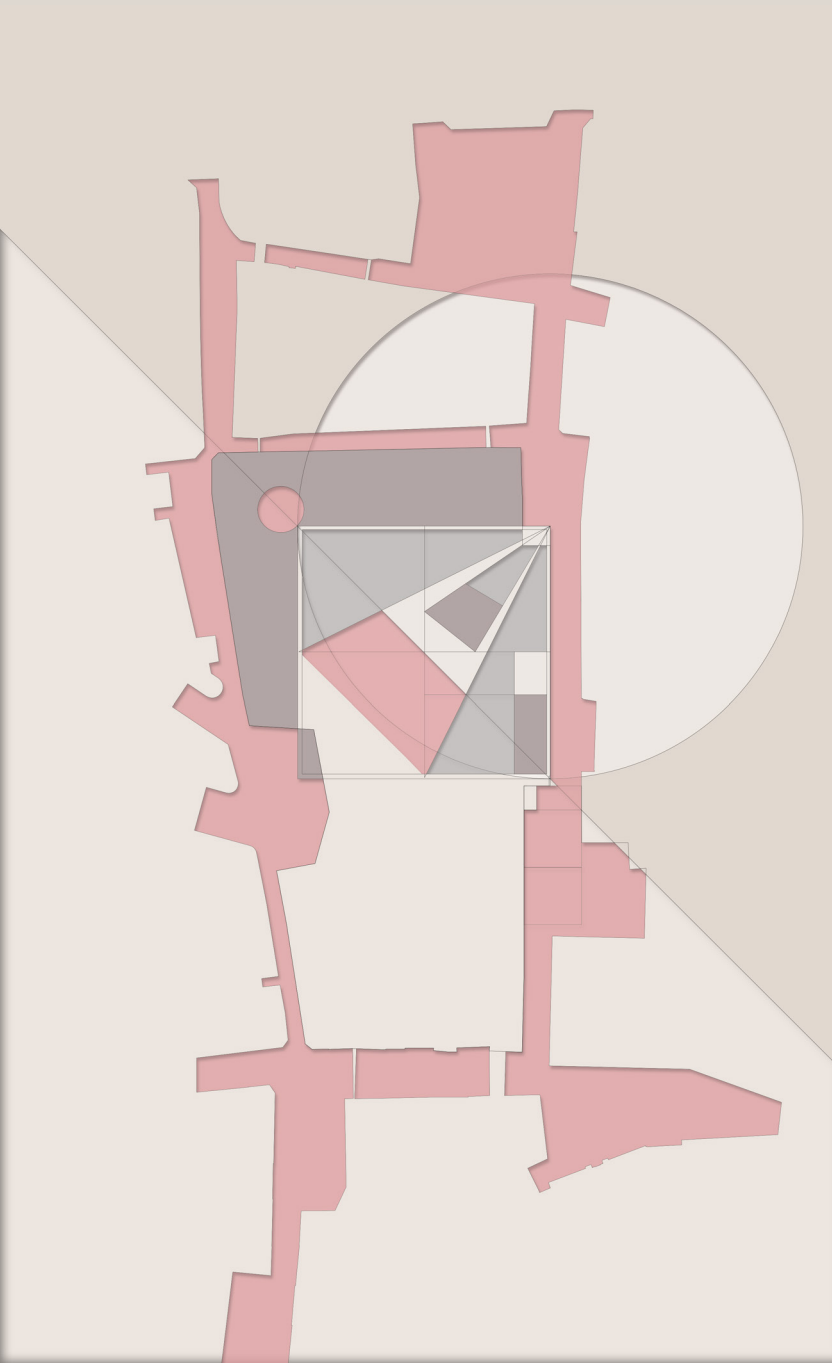

Contextual Geometric Unity
with establishment of coherent street routes

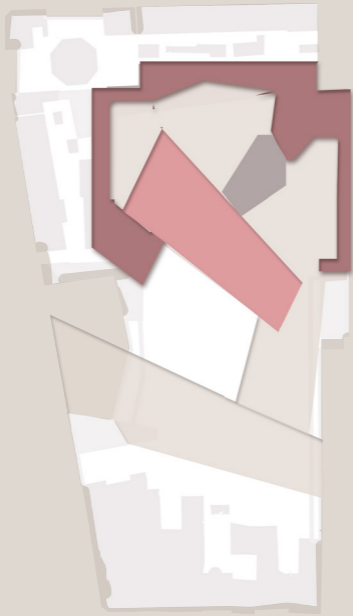

Logistics;
Lower to Upper Ground Connection

1: 'Back of House'

2: House of Fairytales
performance stage

3: the 'Total Environment',
connected to moveable roof
above for 'Stadium/Arena'
performances in
the Landscape of Child

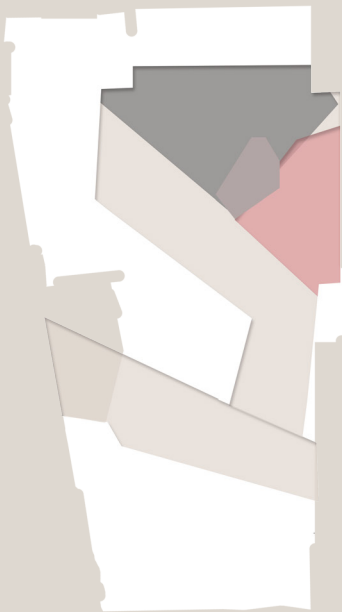

Curation: 1
Conventional

1: 'Hans Christian Anderson
Museum'
(Medium)

2: 'TinderBOX'
(Methods)

3: 'House of Fairy Tales'
(Messages)



Curation: 2
ANT version

1: ***'Total Environment'***
of the world of
Hans Christian Anderson and
the Fairytales as a series of
exhibitions relating to the:

Scripts and the Messages of Tales

Actants and the Mediums of Tales

Networks and the Methods of Tales



Curation: 3
Hybrid

1: 'Hans Christian Anderson
Museum'

2: 'TinderBOX'

3: 'House of Fairy Tales'
'Total Environment'





